



CAUTION

Before use, thoroughly read MAXAIR® CAPR® P/N 03521015 User Instruction (received with all CAPR Helmets and available at www.maxair-systems.com).



- REF** 2271PB-100SM
(Small-Medium)
- P/N** 08031005
- REF** 2271PB-100ML
(Medium-Large)
- P/N** 08031006

Intended Use

The MAXAIR CAPR Hood Systems filter aerosolized and droplet particulates and provide high level fluid resistance when used with a MAXAIR CAPR Powered Air Purifying Respirator (PAPR) Helmet.

Hoods are designed for single use applications.

Standard CA-CAPR-36 System with 2271PB-100 DLC Single Hood



Symbol Definitions



Warning, Caution, or Note

REF Catalog Number **P/N** NIOSH Number



WARNING

Failure to follow User Instructions P/N 03521015 and the instructions contained herein may be hazardous to the user's health.

Use only if package is received unopened and contents are undamaged. If damage is noted, contact the shipper for replacement or repair.

Prior to using any MAXAIR® System or component, be sure to be familiar with the system's NIOSH approved configuration.

DO NOT use if any component is damaged. If any components are damaged or contaminated and therefore unfit for safe and effective use, they should be replaced immediately.

Only trained and experienced personnel who have read and understand the User Instructions should use MAXAIR Products.

The institution using this product in any application is responsible for determining the appropriateness of this equipment relative to regulatory requirements. Bio-Medical Devices Intl, Inc. does not recommend the appropriate systems for a particular institution or facility.

Use only MAXAIR Systems/ NIOSH approved compatible components.

NOT for use in atmospheres immediately dangerous to life or health (IDLH), and atmospheres containing less than 19.5% oxygen, or more than 25% oxygen.

Flammability Level I: fabric may burn if exposed to open flame.

Follow current local regulations governing biohazard waste to safely dispose of single use MAXAIR Products.

If you need more information, contact your BMDI Sales Representative, or call BMDI customer service at 1-800-443-3842.

1. 2081-03 Helmet (includes 2051-07 SnapOn Cage, 2071-08 Liner, 2590-05 Power Cord)	2. 2271PB-100 Hood
	3. 2061-05 HFR FCC (High Fluid Resistance Filter Cover Cap)
4. 36TSC Battery*	5. 2000-76 Battery Belt
6. 2600-02 Battery Charger**	

*Alternate Batteries include the 2500-37TSC and 2500-30TSC.
** Alternate Charger includes the 2600-01.

Specifications

MATERIAL	TYPE	FLUID RESISTANCE
Body (Shroud)	Polypropylene	ASTM F1671
Lens	Polycarbonate	ASTM F1671
Hood Filter	Polypropylene	AATCC TM127

Recommended System Temperature Limits

Use/Handling: 0°C to 54°C at a maximum 80% Relative Humidity.
Charging: 0°C to 45°C at a maximum 80% Relative Humidity.
Storage: 0°C to 35°C at a maximum 80% Relative Humidity.

Regulatory

NIOSH PAPR100-N

Assembly and Donning - Battery and Belt



Assemble the Battery onto a double layer of Belt.
Place top edge of Belt under the Battery Clip, up to the Clip top, so the Clip Detent rests on the Clip Base and NOT the Belt.
Place the belt comfortably around the waist with the battery near the side-back of the right hip.

Assembly and Donning - Hood (generally start with the ML Size unless the wearer has a very small head size)



1. Attach (snap) center Hood-Lens mounting hole over Helmet center mounting post.



2. Gently pull Cuff and Flappers away from the Lens to ensure they are not stuck together.



3. Attach (snap) one side Hood-Lens mounting hole to respective Helmet side mounting post. Repeat on other side.



4. Grasp the back of the Hood Filter and begin to pull the Hood up and over the Helmet.



5. Continue pulling the Hood over the Helmet down to within about 1-2 inches from the top rear Helmet Snap.

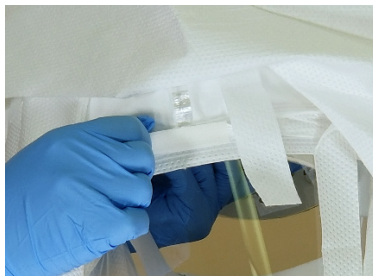

6. If the Hood Filter is folded over the front Velcro Strip, "flip" the fold up to expose the Velcro Strip. Pull the Hood down further in back to remove the wrinkles from the Hood Filter.



7. Connect the Helmet Power Cord to the Battery by pushing its Connector into the Battery Receptacle until the Secure Connection audibly clicks.



8. Ensure the Cuff Flappers are away from the Lens and in front of the Liner Side Tabs.



9. Loosen the ratchet adjustment knob counter-clockwise to ensure the Helmet will easily fit over the head.

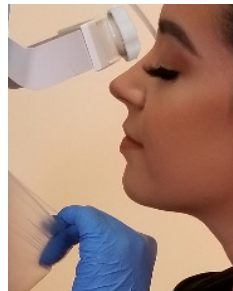

10. Hold the Helmet in one hand, pull the front top edge of the Cuff down, and place your chin into the Cuff. Then, pull the Helmet over and down on to your head.

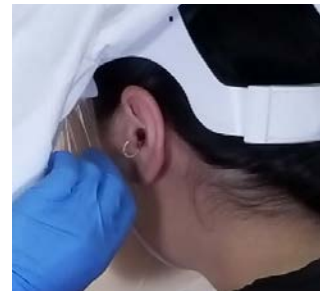

11. Slide fingers between Cuff and face from temples down and under chin to pull Cuff Flappers away from Lens, and to properly position the Cuff.

WARNING
If conditions 1 and 2 both are not achieved, switch to the SM size and repeat Assembly and Donning steps 1-11.



Condition 1: Ensure the DLC Flappers are away from the Lens, positioned perpendicular to your temples, and in front of the FCC Side Tabs.



Condition 2: Ensure slight tension is felt while sliding the index or first finger between cuff and face all along chin and up to temples, from right side of the face to the left.



12. Tighten Ratchet Knob (clockwise) as tight as possible without causing discomfort to secure Helmet on head for all anticipated activities.



13. Pull Hood Shroud down all around.



14. Don appropriate body gown per gown manufacturer's protocol. Keep Hood Shroud up while closing gown so Hood is outside of gown.

Don HFR FCC (Optional, depending upon fluid resistance protection desired.)



1. Align the front centerline of the HFR FCC with the front centerline of the Hood and position the HFR FCC over the Hood so that both front bottoms align.



2. Pull HFR FCC over and down in back to cover the entire Hood Filter.



3. Hold the underneath back of the Helmet steady with the thumb while pulling the back of the HFR FCC fully down to even with the bottom rear of the Helmet.

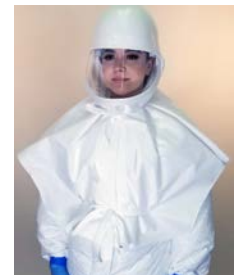

4. Ensure Hood Shroud is down all around, then pull ties from behind and tie securely in front.

Doff HFR FCC (If it was Donned)



1. Holding the front of the HFR FCC steady, push up its rear to begin lifting it up and off the Helmet.



2. Continue to lift the HFR FCC rear up and off the Hood/Helmet.



3. Continue lifting until the HFR FCC is completely clear of the Helmet; decon appropriately for next use.

Doff the Hood, Helmet, Battery and Belt



WARNING

Discard all disposables and body gown per Institutional protocol for contaminated waste.



1. Untie both neck and body Ties, pull through their loops and discard appropriately.



2. Roll up Hood from Shroud back bottom up and over to top front of Helmet.



3. Unsnap each side Flapper and continue moving rolled Hood forward and off front Helmet Mounting Post.



4. With Hood completely off Helmet discard appropriately.

5. Doff body gown per gown manufacturer's protocol and discard appropriately.



6. Loosen the rear Headband Adjustment Knob (turn counterclockwise).



7. Lift Helmet up and off head.



8. Unbuckle Belt and remove Battery and Belt from around the waste.

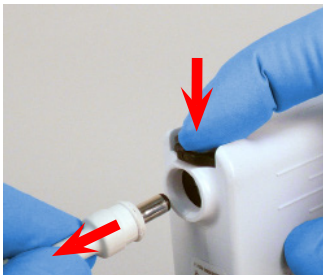

9. Disconnect the Helmet Power Cord from the Battery - Press down on the Secure Lock (Black) Button to release, then pull the cord connector out from the Battery connection receptacle.



10. With Charger connected to safe power source, connect Charger Cord to the Battery. Push Charger Cord Connector into Battery Receptacle until fully seated.



WARNING

Refer to Users Instructions (P/N 03521015) for details on chargers and charging batteries.



The entire CAPR System may be decontaminated, cleaned and/or stored at this time.