



### CAUTION

Before use, thoroughly read MAXAIR® CAPR® P/N 03521015 User Instruction (received with all CAPR Helmets and available at [www.maxair-systems.com](http://www.maxair-systems.com)).



**REF** 2272PB-100SM

(Small-Medium)

**P/N** 08031025

**REF** 2272PB-100ML

(Medium-Large)

**P/N** 08031026

### Symbol Definitions



Warning, Caution, or Note

**REF** Catalog Number    **P/N** NIOSH Number



### WARNING

Failure to follow User Instructions P/N 03521015 and the instructions contained herein may be hazardous to the user's health.

Use only if package is received unopened and contents are undamaged. If damage is noted, contact the shipper for replacement or repair.

Prior to using any MAXAIR® System or component, be sure to be familiar with the system's NIOSH approved configuration.

DO NOT use if any component is damaged. If any components are damaged or contaminated and therefore unfit for safe and effective use, they should be replaced immediately.

Only trained and experienced personnel who have read and understand the User Instructions should use MAXAIR Products.

The institution using this product in any application is responsible for determining the appropriateness of this equipment relative to regulatory requirements. Bio-Medical Devices Intl, Inc. does not recommend the appropriate systems for a particular institution or facility.

Use only MAXAIR Systems/ NIOSH approved compatible components.

NOT for use in atmospheres immediately dangerous to life or health (IDLH), and atmospheres containing less than 19.5% oxygen, or more than 25% oxygen.

Flammability Level I: fabric may burn if exposed to open flame.

Follow current local regulations governing biohazard waste to safely dispose of single use MAXAIR Products.

If you need more information, contact your BMDI Sales Representative, or call BMDI customer service at 1-800-443-3842.

### Intended Use

The MAXAIR CAPR Hood Systems filter aerosolized and droplet particulates and provide high level fluid resistance when used with a MAXAIR CAPR Powered Air Purifying Respirator (PAPR) Helmet.

Hoods are designed for single use applications.

### Standard CA-CAPR-36 System with 2272PB-100 Double Hood



1. 2081-03 Helmet (includes 2051-07 SnapOn Cage, 2071-08 Liner, 2590-05 Power Cord)	2. 2272PB-100 Hood
	3. 2061-05 HFR FCC
4. 2500-36TSC Battery*	5. 2000-76 Battery Belt
6. 2600-02 Battery Charger	

\*Alternate Batteries include the 2500-37TSC.

### Specifications

MATERIAL	TYPE	FLUID RESISTANCE
Body (Shroud)	Polypropylene	ASTM F1671
Lens	Polycarbonate	ASTM F1671
Hood Filter	Polypropylene	AATCC TM127
HLF	Polypropylene/modacrylic blend	General particle filter material

### Recommended System Temperature Limits

Use/Handling: 0°C to 54°C at a maximum 80% Relative Humidity.  
Charging: 0°C to 45°C at a maximum 80% Relative Humidity.  
Storage: 0°C to 35°C at a maximum 80% Relative Humidity.

### Regulatory

NIOSH PAPR100-N

### Assembly and Donning - Battery, Belt, Helmet and Hood

1. Remove all System Components from their packaging, ensure they are ready for use, and lay them on a clean counter with labels facing you.



2. Assemble the Battery onto a double layer of Belt. Place top edge of Belt under the Battery Clip, up to the Clip top, so the Clip Detent rests on the Clip Base and NOT the Belt. Place the belt comfortably around the waist with the battery near the side-back of the right hip.

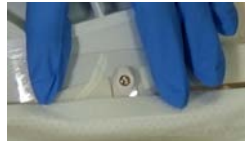

3. Attach (snap) center Hood-Lens mounting hole over Helmet center mounting post.



4. Attach (snap) one side Hood-Lens mounting hole to respective Helmet side mounting post. Repeat on other side.



5. Grasp the back of the Hood Filter and begin to pull the Hood up and over the Helmet.



6. Continue pulling the Hood over the Helmet down to within about 1-2 inches from the top rear Helmet Snap.

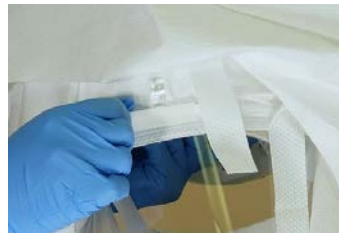

7. If the Hood Filter is folded over the front Velcro Strip, "flip" the fold up to expose the Velcro Strip. Pull the Hood down further in back to remove the wrinkles from the Hood Filter over the Helmet top.



8. Connect Helmet Power Cord to Battery. Push Power Cord Connector into Battery Receptacle until Secure Connection audibly clicks.



9. Loosen the ratchet adjustment knob counter-clockwise to ensure the Helmet will easily fit over the head.



10. Pull the Helmet over and down on to your head.



11. Tighten Ratchet Knob (clockwise) as tight as possible without causing discomfort to secure Helmet on head for all anticipated activities.



12. Pull Hood Shrouds over top of Helmet and down in back.



13. Pull Hood Shrouds down all around.



14. Grasp Hood front just below Lens and Hood back just below Filter. Pull down firmly to smooth out any wrinkles of the Filter.



15. Place back of outer Shroud over Helmet and don outer gown per gown manufacturer's protocol. Place inner Shroud inside outer gown and close gown. Pull outer shroud down all around gown.



16. Pull Neck ties loose from behind, pull them around in front and tie securely, within approximately one-half inch of the neck. Similarly, loosen body ties and pull them around and through the slots in the lower front outer shroud, and tie securely.



### Don the Optional HFR FCC (High Fluid Resistance Filter Cover Cap)

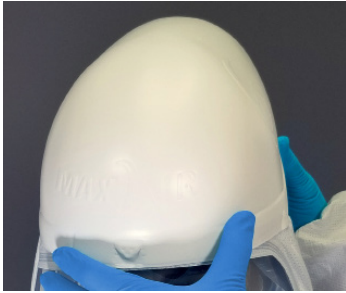

1. Align the front centerline of the HFR FCC with the front centerline of the Hood and position the HFR FCC over the Hood so that both front bottoms align.



2. Pull HFR FCC over and down in back to cover the entire Hood Filter.



3. Hold the underneath back of the Helmet steady with the thumb while pulling the back of the HFR FCC fully down to even with the bottom rear of the Helmet.

### Do off the Optional HFR FCC (High Fluid Resistance Filter Cover Cap)



1. Holding the front of the HFR FCC steady, push up its rear to begin lifting it up and off the Helmet.



2. Continue to lift the HFR FCC rear up and off the Hood/ Helmet.



3. Continue lifting until the HFR FCC is completely clear of the Helmet; de-con appropriately for next use.

### Doff the Hood, Helmet, Battery and Belt

**WARNING**  
Discard all disposables and body gown per Institutional protocol for contaminated waste.



1. Untie both neck and body Ties, pull through their loops and discard appropriately.



2. Roll up outer shroud to above the body gown.



3. Open the body gown, reach back and pull the Inner Shroud up and out, to cover Outer Shroud.



4. Continue to roll up both Shrouds, inside over outside, up and over Helmet.



5. Unsnap each side attachment and continue moving rolled Hood forward and off front Helmet Mounting Post.



6. With Hood completely off Helmet discard appropriately.

7. Doff body gown per gown manufacturer's protocol and discard appropriately.



8. Loosen the rear Headband Adjustment Knob (turn counterclockwise).



9. Lift Helmet up and off head.



10. Unbuckle Belt and remove Battery and Belt from around the waste.

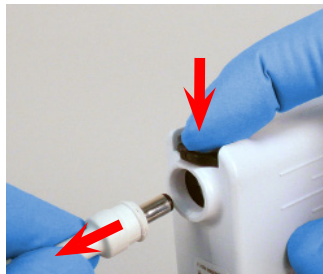

00. Disconnect the Helmet Power Cord from the Battery - Press down on the Secure Lock (Black) Button to release, then pull the cord connector out from the Battery connection receptacle.



12. With Charger connected to safe power source, connect Charger Cord to the Battery. Push Charger Cord Connector into Battery Receptacle until fully seated.

**WARNING**  
Refer to Users Instructions (P/N 03521015) for details on chargers and charging batteries.



The entire CAPR System may be decontaminated, cleaned and/or stored at this time.