



CAUTION

Before use, thoroughly read and understand the MAXAIR® CAPR® P/N 03521015 User Instruction (shipped with all CAPR Helmets and available at www.maxair-systems.com, Resources, User Instructions).



REF 2061-04A

PN 01031528

Symbol Definitions



Warning, Caution, or Note



Catalog Number



Part Number



WARNING

Failure to follow User Instructions P/N 03521015 and the instructions contained herein may be hazardous to the user's health.

Use only if package is received unopened and contents are undamaged. If damage is noted, contact the shipper for replacement or repair.

Prior to using any MAXAIR® System or component, be sure to be familiar with the system's NIOSH approved configuration.

DO NOT use if any component is damaged. If any components are damaged or contaminated and therefore unfit for safe and effective use, they should be replaced immediately.

Only trained and experienced personnel who have read and understand the User Instructions should use MAXAIR Products.

The institution using this product in any application is responsible for determining the appropriateness of this equipment relative to regulatory requirements. Bio-Medical Devices Intl, Inc. does not recommend the appropriate systems for a particular institution or facility.

Use only MAXAIR NIOSH approved respirator configurations.

NOT for use in atmospheres immediately dangerous to life or health (IDLH), and atmospheres containing less than 19.5% oxygen, or more than 25% oxygen.

Flammability Level I: fabric may burn if exposed to open flame.

Follow current local regulations governing biohazard waste to safely dispose of single use MAXAIR Products.

If you need more information, contact your BMDI Sales Representative, or call BMDI customer service at 1-800-443-3842.

Intended Use

The MAXAIR CAPR Hard Hat provides Type 1 Hard Hat impact protection when used with a MAXAIR CAPR Powered Air Purifying Respirator (PAPR) Helmet.

Typical CA-CAPR-HH-36 Base System with 2061-04A Hard Hat and 2180XP-07 Filter

1



2



3



4



5



6



1. 2083-03 Helmet with 2071-07 Liner, 2590-05 Power Cord and 2051-08 Cage

2. 2500-36TSC Battery

3. 2000-76 Battery Belt

4. 2600-02 Battery Charger

5. 2061-04A Hard Hat

6. 2180XP-07 Filter

Hard Hat Configurations

Alternates

3262-5H Double Shroud
2500-37TSC Li-Ion Battery

Options

2400-090L Impact Lens
2400-208 Peel Away Lens
2000-210 Chinstrap

Specifications

Material

Glass filled Nylon

Recommended System Temperature Limits

Use/Handling: 0°C to 54°C at a maximum 80% Relative Humidity.

Charging: 0°C to 45°C at a maximum 80% Relative Humidity.

Storage: 0°C to 35°C at a maximum 80% Relative Humidity.

Performance

FACE/HEAD COVER	FILTER	APF
3262-5H Double Shroud	2180XP-07	1,000

Regulatory

•NIOSH HE •ANSI/ISEA Z98.1-2014 Type 1, Class G & C

Assembly - 2061-04A Hard Hat to 2083-03 Helmet with Filter already assembled



WARNING

A Filter Cartridge or Filter must to be installed on the Helmet before use.

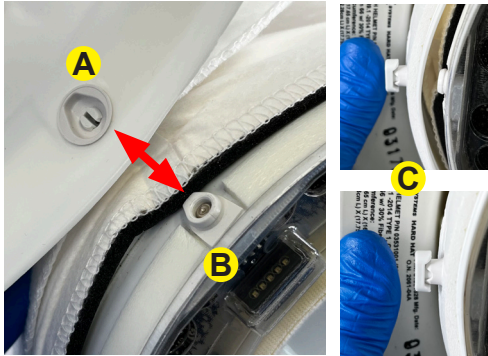

1. Align the inside of the Hard Hat Front Adapter (A) to the Helmet Front Adapter (B) and press the Helmet Front Adapter into the inside of the Hard Hat Front Adapter (C).

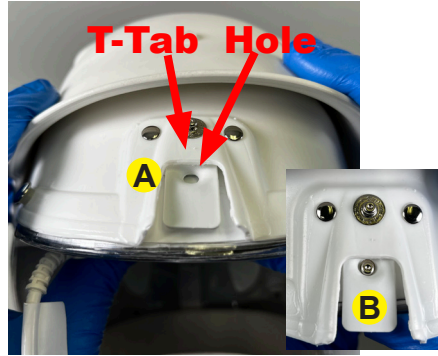

2. Place the Hard Hat over and down onto the Helmet, and press them together until the Hard Hat T-Tab Hole (A) snaps securely over onto the Helmet rear Bottom Snap (B).



3. Ensure that each Hard Hat Side Adapter is fully down over each Helmet Side Adapter.

Disassembly - 2061-04A Hard Hat from 2083-03 Helmet with Filter assembled



1. With one hand, hold the Helmet and Hard Hat. With the other hand, pull up and out on the Hard Hat T-Tab and unlatch it from the Hard Hat Rear Bottom Snap.



2. Continue holding the T-Tab away from the Helmet while lifting the Hard Hat up and completely off the helmet.

