

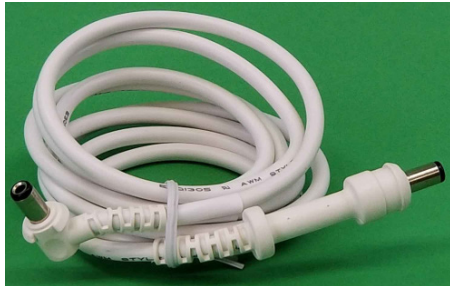

CAUTION

Before use, thoroughly read MAXAIR® CAPR® P/N 03521015 User Instruction (received with all CAPR Helmets and available at www.maxair-systems.com).



REF 2590-05
(59 inch long)

P/N 2590-05

REF 2590-08
(47 inch long)

P/N 00722184

Intended Use

The MAXAIR Power Cords connect a MAXAIR Systems Belt Mounted Li-Ion Battery to a MAXAIR Systems Helmet.

Specifications

Material

Cord Cover: White PVC

Electrical Connections

Both Connectors: 

Recommended System Temperature Limits

Use/Handling: 0°C to 54°C at a maximum 80% Relative Humidity.

Charging: 0°C to 45°C at a maximum 80% Relative Humidity.

Storage: 0°C to 35°C at a maximum 80% Relative Humidity.

Symbol Definitions



Warning, Caution, or Note



Catalog Number



NIOSH Number



WARNING

Failure to follow User Instructions P/N 03521015 and the instructions contained herein may be hazardous to the user's health.

Use only if package is received unopened and contents are undamaged. If damage is noted, contact the shipper for replacement or repair.

Prior to using any MAXAIR® System or component, be sure to be familiar with the system's NIOSH approved configuration.

DO NOT use if any component is damaged. If any components are damaged or contaminated and therefore unfit for safe and effective use, they should be replaced immediately.

Only trained and experienced personnel who have read and understand the User Instructions should use MAXAIR Products.

The institution using this product in any application is responsible for determining the appropriateness of this equipment relative to regulatory requirements. Bio-Medical Devices Intl, Inc. does not recommend the appropriate systems for a particular institution or facility.

Use only MAXAIR NIOSH approved respirator configurations.

NOT for use in atmospheres immediately dangerous to life or health (IDLH), and atmospheres containing less than 19.5% oxygen, or more than 25% oxygen.

Flammability Level I: fabric may burn if exposed to open flame.

Follow current local regulations governing biohazard waste to safely dispose of single use MAXAIR Products.

If you need more information, contact your BMDI Sales Representative, or call BMDI customer service at 1-800-443-3842.

Regulatory

NIOSH



CAUTION

The 2590-05 and 2590-08 Power Cords are for use with 2500 Series MAXAIR Li-Ion Batteries (LIBs). Older Power Cords do not have the correct connector. The 2590-05 and 2590-08 are compatible with older style MAXAIR LIBs. The older cords do not connect reliably with the 2500 Series LIBs and must not be used with these new LIBs.

Exchange Power Cords on 2070-03 and 2075-03 Helmets Only

When you purchase a new 2500 Series LIB you will receive a new Turn Lock style power cord with it. You must discard all older power cords when you receive your new 2500 Series LIBs to ensure you are always using the correct Turn Lock style connector, regardless of newer or older battery.



1. Firmly grasp the flat sides of the older Power Cord-to-Helmet Connector.



2. Firmly lift the Power Cord-to-Helmet Connector up and out of the Helmet receptacle.



3. Place the newer Power Cord-to-Helmet Connector into the Helmet receptacle and push in until it is firmly seated.



NOTE

Connector shown in the following is the Turn Lock style for the 2080 series Helmets, the 2081-03, 2083-03, and the 2084-04.

Assembly - Cord to Helmet

Cord Notch

Helmet
Turn Lock
style
Connector
Tab

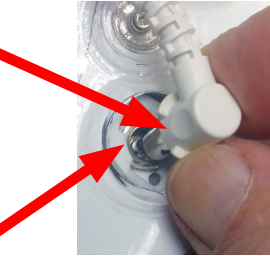

1. Align Cord notch with
Helmet connector tab.



2. Push Cord connector fully to
bottom of Helmet connector.



3. Turn Cord towards back of
Helmet to secure the connection.

Assembly - Cord to Battery



1. Connect the Power Cord connector to the Battery.
Do NOT push down on the Battery Secure Lock
(Black) button.



2. Push Power Cord connector in to the Battery Con-
nector fully until an audible click is heard.

Disassembly - Cord from Battery



1. Depress the Secure Connection Button.

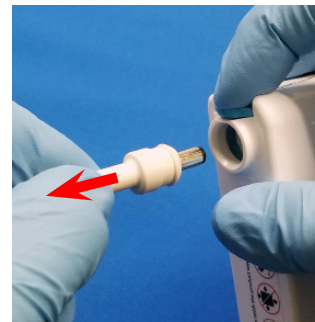

2. Pull Cord Connector out. Release the Button.

Disassembly - Cord from Helmet



1. Align Cord notch with Helmet connector tab.



2. Lift Cord connector up and away from Helmet.