



## CAUTION

Before use, thoroughly read and understand User Instructions P/N 03521015 included with each shipped CAPR Helmet and available at [maxair-systems.com](http://maxair-systems.com), Resources, User Instructions.



**REF** 3262-5H

**P/N** 04231001

## Symbol Definitions



Warning, Caution, or Note

**REF**

Catalog Number

**P/N**

NIOSH Number



## WARNING

Failure to follow User Instructions P/N 03521015 and the instructions contained herein may be hazardous to the user's health.

Use only if package is received unopened and contents are undamaged. If damage is noted, contact the shipper for replacement or repair.

Prior to using any MAXAIR® System or component, be sure to be familiar with the system's NIOSH approved configuration.

DO NOT use if any component is damaged. If any components are damaged or contaminated and therefore unfit for safe and effective use, they should be replaced immediately.

Only trained and experienced personnel who have read and understand the User Instructions should use MAXAIR Products.

The institution using this product in any application is responsible for determining the appropriateness of this equipment relative to regulatory requirements. Bio-Medical Devices Intl, Inc. does not recommend the appropriate systems for a particular institution or facility.

Use only MAXAIR NIOSH approved respirator configurations.

NOT for use in atmospheres immediately dangerous to life or health (IDLH), and atmospheres containing less than 19.5% oxygen, or more than 25% oxygen.

Flammability Level I: fabric may burn if exposed to open flame.

Follow current local regulations governing biohazard waste to safely dispose of single use MAXAIR Products.

If you need more information, contact your BMDI Sales Representative, or call BMDI customer service at 1-800-443-3842.

## Intended Use

The MAXAIR 3262-5H is a disposable full facepiece cover. It is a component of a NIOSH approved HE system that filters incoming aerosolized and droplet particulates. It is to be donned with a MAXAIR CAPR® Helmet with an installed HE Filter. The Helmet is to be powered by a MAXAIR Li-Ion Battery.

## Typical Complete System with 3262-5H Double Shroud



1. 2081-03 Helmet, 2051-08 Cage, 2071-07 Liner, 2590-05 Power Cord <sup>1</sup>	2. 2180XP-07 Filter Cap <sup>2</sup>
	3. 2061-04A Hard Hat <sup>3</sup>
4. 2500-36TSC Battery <sup>4</sup>	5. 2000-76 Battery Belt <sup>5</sup>
6. 2600-02 Battery Charger	7. 3262-5H Double Shroud

1 Alternate Power Cords include the 2590-08

2 Alternate Filters include the 2167-10 Filter Cartridge

3 Alternate Covers include the 2061-08 & 2061-09 Filter Cover Caps

4 Alternate Batteries include the 2500-37TSC

5 Alternate Belts include the 2000-77 and 2000-78

## Specifications

### Materials

DLC Lens is PETG

DLC Cuff is Polyurethane

Shroud outer body is plastic coated fabric

Shroud inner body is electrostatic filter media

All MAXAIR components and disposables are latex free.

### Recommended System Temperature Limits

Use/Handling: 0°C to 54°C at a maximum 80% Relative Humidity.

Charging: 0°C to 45°C at a maximum 80% Relative Humidity.

Storage: 0°C to 35°C at a maximum 80% Relative Humidity.

## Regulatory

NIOSH HE



## WARNING

Ensure the appropriate filter and the 2061-04A Hard Hat are properly assembled to the 2081-03 CAPR Helmet before beginning assembly of the Double Shroud.



## NOTE

### Without a Helper:

First perform steps in "2. Assembly: Shroud to Hard Hat"

Next, perform steps in "1. Assembly and Donning: Battery, Belt, and Hard Hat"

Next, perform steps in 3. and 4.

**With a Helper:** follow the steps in the sequence as presented, 1-4, in the following Instructions.

## 1. Assembly and Donning: Battery, Belt, and HardHat

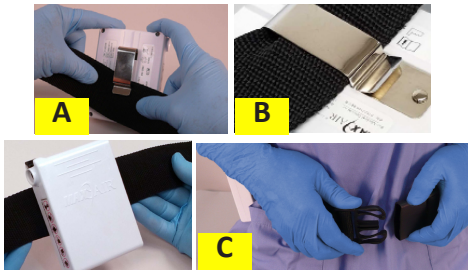

1. Assemble the Battery onto the Belt - Place top edge of Belt under top edge of Battery Clip (A), so Clip Detent rests on Clip Base and NOT Belt (B); place belt around waist with battery near side-back of right hip (C).



2. Connect Helmet Power Cord to Battery; push Power Cord Connector into the Battery Receptacle until the Secure Connection audibly clicks.



3. Loosen headband Ratchet Knob (counterclockwise).



4. Pull the Helmet over and down on head. (The Shroud would be assembled if performing without a Helper.)



5. Tighten Ratchet Knob secure as comfortably possible, while ensuring stability.

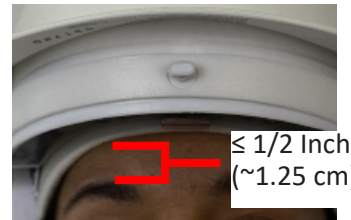

6. Position front headband within 1/2 inch of eyebrows for good visualization of the Safety LEDs.

## 2. Assembly: Shroud to Hard Hat



1. Remove Shroud from packaging; note Shroud is turned inside-out to mount to Hard Hat/Helmet.



2. Turn all three Hard Hat TurnClips horizontally (A), attach Shroud front Mounting Hole over the front Hard Hat TurnClip. Turn the TurnClip vertically to secure (B).



3. Maintaining pressure on the DLC Lens against the Hard Hat front white Foam Strip, press and slide your thumb down one side and press that side-front Lens Slot over and down on that Hard Hat side TurnClip.



4. Continue pressing against the foam strip and press that side Lens back Slot over that side Hard Hat Mounting Post. (There is an audible "click" when properly secured.)



5. Repeat steps 4 and 5 for the other side Lens slots and Hard Hat TurnClips and Mounting Post.



6. Pull Shroud top fabric up and over the front TurnClip; tuck it under all around the Hard Hat bottom edge.

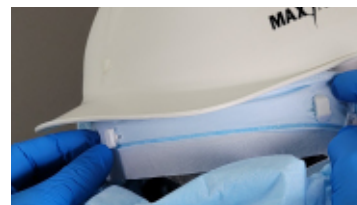

7. Push the fabric up and over over the front and side TurnClips, then secure the Lens in place by turning all three TurnClips vertically.

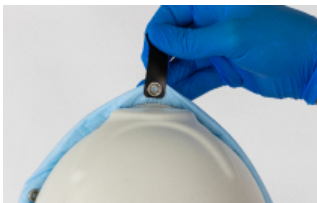

8. Use the Pull Tab to pull the Shroud over and down the back of the Hard Hat.



9. Use Pull Tap to secure the Shroud Rear Snap onto the Hard Hat Rear Snap.



10. Snap and secure left Rear Side Snaps between Shroud and Hard Hat. Then repeat on right Rear Side Snaps.

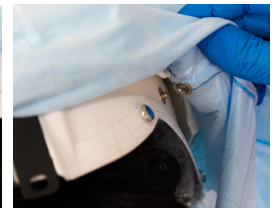

### 3. Donning Shroud and Gown (as desired)



1. With the inner Shroud down all around and the outer shroud up, pull the inner shroud neck ties to the front and tie securely, leaving about a 1/2 inch gap between neck and Shroud.



2. Down the desired body gown per its manufacturer's instructions over the Inner Shroud of the Shroud.



3. Complete donning and closing the desired body gown, per its manufacturer's instructions, over the inner Shroud.



4. After fully closing the body gown, pull the Shroud outer Shroud down all around.



### 4. Doffing



#### WARNING

Discard ties, Shroud, and body gown per Institutional protocol for contaminated waste.



1. Open the body gown enough to untie the inner Shroud Tie.



2. Unsnap the rear and both back-side Shroud Snaps from the Hard Hat.

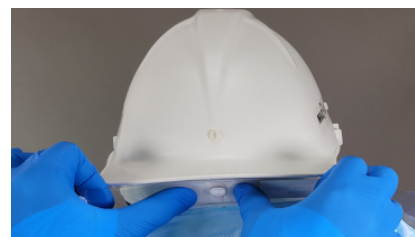
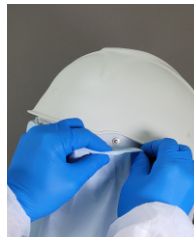

3. Pull the fabric along the front and sides of the Lens down so that you can turn all three TurnClips horizontally.



4. Begin rolling up the Outer Shroud from the bottom, inside-over-outside. When above the neck line, begin pulling and rolling the Inner Shroud in with the Outer Shroud.



5. When you reach the level of the bottom edge of the Hard Hat pull the Shrouds out, over, and up on to the Hard Hat top.



6. Continuing the rolling motion to the middle of the Hard Hat and pull the sides of the Lens from the Side Mounts and TurnClips.



7. Continue pulling and rolling to the front. Pull the Lens front Mounting Hole off the front Hard Hat TurnClip and free the entire Shroud from the Hard Hat/Helmet.

8. Remove the body cover per its manufacturers' instructions.



9. Loosen the Helmet Ratchet Knob (counterclockwise).



10. Lift the Helmet up, forward, and off the head.

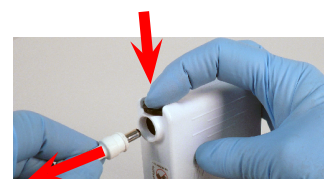

11. Disconnect the Power Cord from the Battery - push the Secure Connection Button down, pull the Cord Connector out, release the Button.



12. Disconnect the Battery Belt from around the waist by un-snapping the buckle.



13. Connect a Charger to a safe power source; connect the Charger Cord Connector into the Battery Receptacle until it is fully seated.



#### WARNING

Refer to the section on chargers and charging batteries for details.



The entire CAPR System may be decontaminated, cleaned and/or stored at this time.